

STEP LIGHTS RPS

A2W12



Fixture Type:

Catalog Number:

Project:

Location:

FINISHES

BK



WT



Model	Forward Voltage	Max Drive Current	Max # of Fixture	Beam	Color Temp	Lumen	Finish
A2W12	6V	300mA	7 per Channel	82	27 2700K 30 3000K	20 58	BK Black WT White

Example: A2W12-27BK

*AISPIRE RPS Required, Sold Separately

DESCRIPTION

Vertical rectangle step light. Designed for safety and style on stairways, patios, decks, balcony areas, walkways and building perimeters.

Features an architectural design. Energy efficient for long-lasting indoor and outdoor lighting solutions. Creates an attractive, romantic impression at night.

FEATURES

- Direct wiring, no driver needed
- Can be painted to match the color of the surface
- Low profile, flush to wall aesthetics with no visible hardware
- 54,000 hour rated life
- Balanced lighting, free of shadows with minimum glare
- 8 year warranty

LINE DRAWING

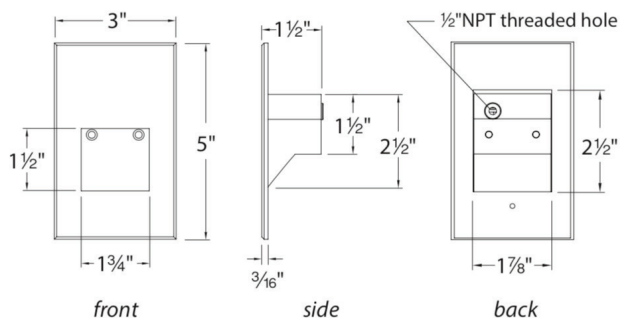

SPECIFICATIONS

Construction:	Die-cast aluminum
Power:	Direct wiring, no remote driver needed. Input voltage: Class 2 Low Voltage, DC power
Dimming:	Refer to RPS specifications for protocol and compatibility
CRI:	90
Mounting:	Fits into 2" x 4" J-Box with minimum inside dimensions of 3"L x 2"W x 2"H Includes bracket for J-Box mount.
Standards:	IP66, UL & cUL Listed for wet locations, Title 24 JA8-2019 Compliant.
Operating Temp:	-4°F to 104°F (-20°C to 40°C)

AiSPiRE® Remote Power Supply (RPS)

A2D LED DMX Power Unit



Model	# of channels	Finish
A2D20 2 x 75W Class 2 output DMX LED power unit	4	BK Black
A2D40 4 x 75W Class 2 output DMX LED power unit	8	

Example: **A2D20-BK**

FINISHES



Black

FEATURES

- 75W Max. Output Power (Per DMX Power Unit)
- 250mA-1500mA output current selection
- Class 2 power supply
- Built-in DMX512 interface
- IP20 rating
- UL Damp location listed

LINE DRAWING

A2D20 - 4 Channel

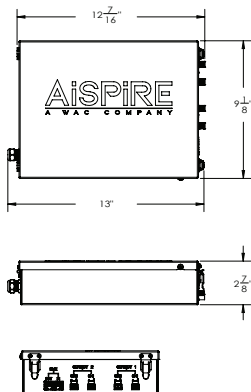

A2D40 - 8 Channel

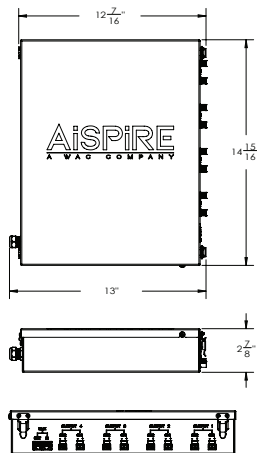

INPUT

Voltage Range:	120VAC
Frequency Range:	50/60Hz
Power Factor:	0.99 @100VAC
THD:	<15% @full load
Current:	0.9A @100VAC
Standby Power Consumption:	<0.5w

OUTPUT

LED Channels:	APD20-BK: 4 Channels APD40-BK: 8 Channels
Selectable Current:	250mA, 300mA, 350mA, 400mA, 450mA, 500mA, 600mA, 700mA, 800mA, 900mA, 1A, 1.1A, 1.2A, 1.3A, 1.4A, 1.5A
DC Voltage Range:	6-48VDC
Current Tolerance:	± 3%
Rated Power:	72W per channel 75W max (per 2-channel output)

CONTROL

Control Protocol:	DMX 512-A, DMX 512
Dimming Range:	0%-100%
Control Input:	DMX RJ45
Dimming Curve:	Linear/Logarithm (Selectable)

PROTECTION

Short Circuit, Over Voltage, Over Temp:	Recovers automatically after fault condition is removed
--	---

ENVIRONMENT

Ambient Operating Temp:	-4°F - 113°C (-20°F - 45°C)
--------------------------------	-----------------------------

SAFETY & EMC

- Safety Standard: UL, Damp Location
- EMC Emission: FCC Part 15 Class B
- Surge Immunity: Line-Line 1 kV

aispire.com
Phone (800) 526.2588
Fax (800) 526.2585

Headquarters
44 Harbor Park Drive,
Port Washington, NY 11050

Georgia Distribution Center
1600 Distribution Ct.
Lithia Springs, GA 30122

Texas Distribution Center
1700 S J Elmer Weaver Fwy Suite 100,
Cedar Hill, TX 75104

California Distribution Center
1750 S Archibald Ave,
Ontario, CA 91760